



Boise Cascade
1-800-541-0529

WALL FRAMING OUTSIDE
VIEW, STUDS,
SHEATHING, ETC...

WOOD PRODUCTS

7/16" OSB SHEATHING

DOUBLE TOP PLATE

HOUSE WRAP A

**HARDIE OR LP
LAP SIDING**

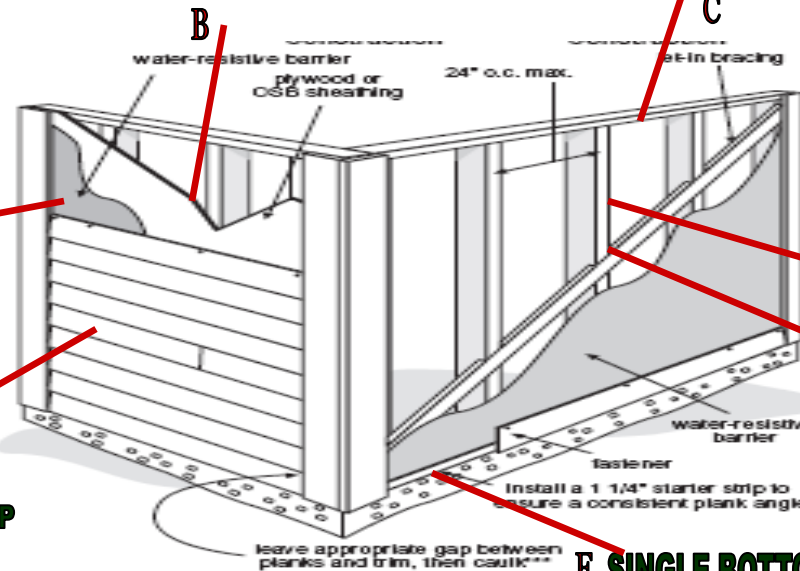

**D 2X6 STUD
16" ON CENTER**

E WALL BRACE

F SINGLE BOTTOM PLATE

| BOISE SKU'S | CORRESPONDING LETTER | PRODUCT DESCRIPTION |
|-------------------|----------------------|---------------------------------------|
| 5300008 | A | 108'X150' BARRICADE BUILDING WRAP |
| 1000030 | B | 7/16" OSB SHEATHING |
| 0115214 | C | 2X6 14' #2 BTR DF DOUBLE BOTTOM PLATE |
| HEIGHT DETERMINED | D | 2X6 STUD 16" OC |

| BOISE SKU'S | CORRESPONDING LETTER | PRODUCT DESCRIPTION |
|---------------------|----------------------|---------------------------------------|
| 5610031 | E | WB126 |
| 0115214 | F | 2X6 14' #2 BTR DF SINGLE BOTTOM PLATE |
| CUSTOMER DETERMINED | G | LP OR HARDIE SIDING |



Boise Cascade
1-800-541-0529

WALL FRAMING INSIDE VIEW

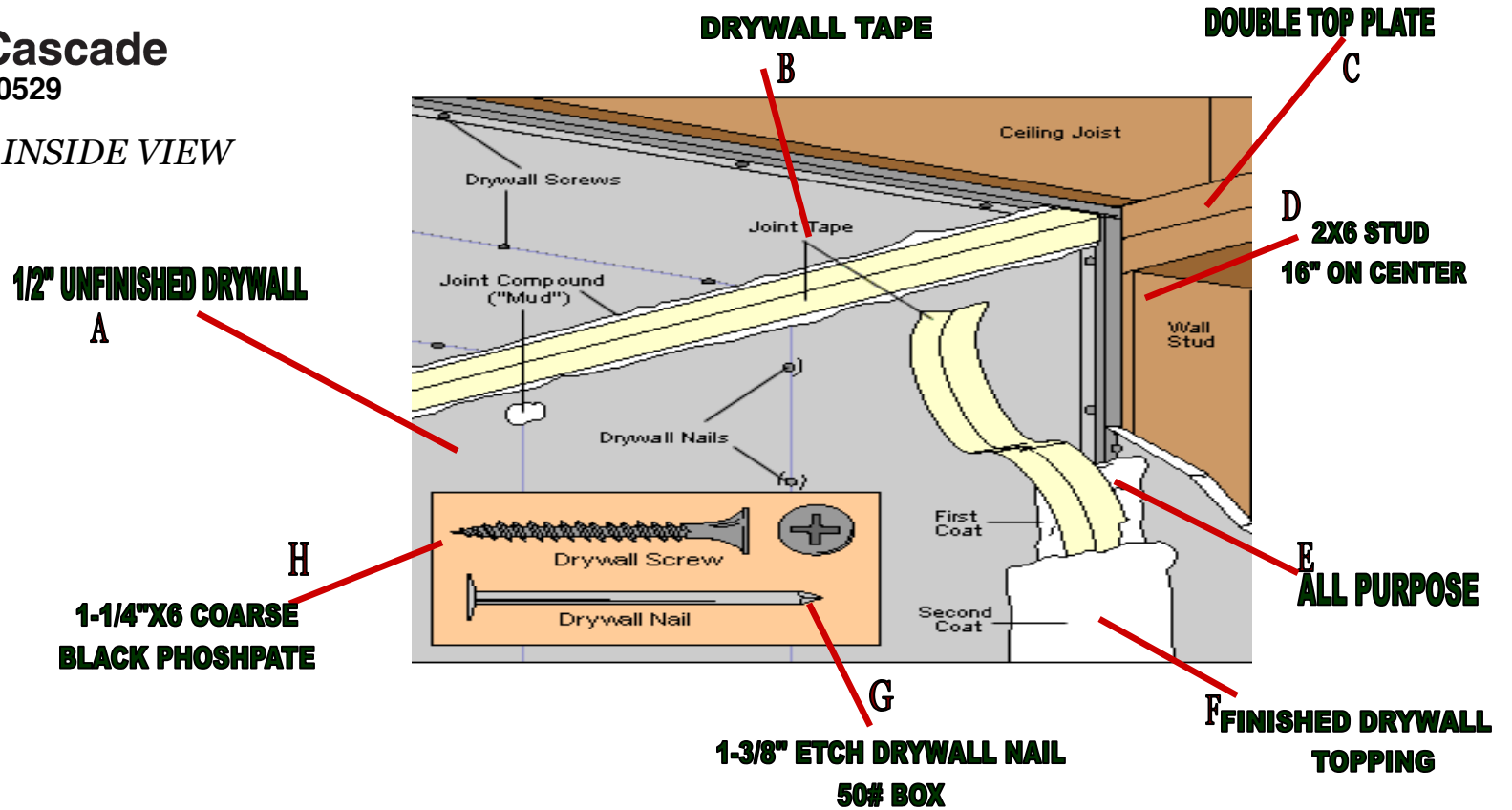

| BOISE SKU'S | CORRESPONDING LETTER | PRODUCT DESCRIPTION |
|--|----------------------|---------------------|
| 3801003 | A | 1/2" 4x12 DRYWALL |
| 250' ROLL 4000056 500' ROLL 4000057 | B | DRYWALL TAPE |
| 0115214 | C | 2X6 14' #2 BTR DF |
| HEIGHT DETERMINED | D | 2X6 STUD 16"OC |

| BOISE SKU'S | CORRESPONDING LETTER | PRODUCT DESCRIPTION |
|-------------|----------------------|---------------------------------|
| 4000004 | E | 50# BOX ALL PURPOSE MUD |
| 4000015 | F | 50# BOX TOPPING |
| 6013001 | G | 1-3/8 ETCH DRYWALL NAIL 50# BOX |
| 6201050 | H | 1-1/4"X6 COARSE BLACK PHOSHPATE |